

# EMO Switch Guard

(Cat \_-AMEGY)

**WARNING**

To prevent electrical shock, disconnect from power source before installing or servicing.



**ATTENTION**

Read this instruction sheet carefully before using the switch guard. This EMO guard is designed for use on semiconductor manufacturing equipment and is SEMI S2 compliant when properly installed per SEMI S2 0706.

## Installation

**NEMA:** For use on a flat surface of a Type 4x indoor use only or Type 13 enclosure. **IEC:**IP66

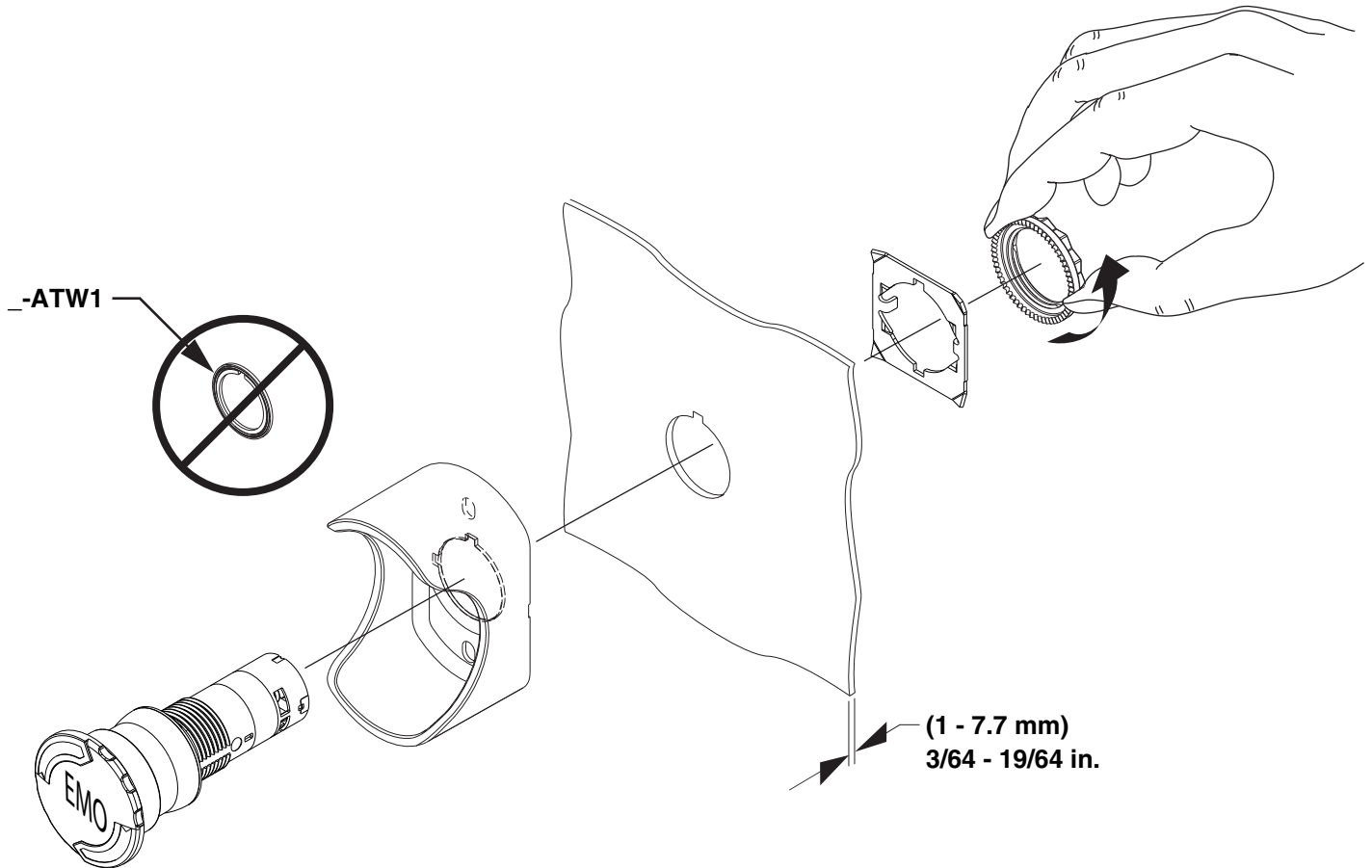

**Mounting Dimensions per SEMI S8 Ergonomic Requirements for reach of critical controls:**

Standing Workstation		Seated Workstation	
Height from floor	Corresponding Depth (from leading edge of workstation)	Height from floor	Corresponding Depth (from leading edge of workstation)
1638 mm (64.5 in)	254 mm (10.0 in)	1397 mm (55.0 in)	366 mm (14.5 in)
1524 mm (60.0 in)	368 mm (14.5 in)	1270 mm (50.0 in)	432 mm (17.0 in)
1422 mm (56.0 in)	432 mm (17.0 in)	1168 mm (46.0 in)	470 mm (18.5 in)
1321 mm (52.0 in)	470 mm (18.5 in)	1067 mm (42.0 in)	483 mm (19.0 in)
1219 mm (49.0 in)	483 mm (19.0 in)	965 mm (38.0 in)	483 mm (19.0 in)
1118 mm (44.0 in)	470 mm (18.5 in)	864 mm (34.0 in)	470 mm (18.5 in)
1016 mm (40.0 in)	394 mm (15.5 in)	762 mm (30.0 in)	445 mm (17.5 in)
914 mm (36.0 in)	292 mm (11.5 in)	660 mm (26.0 in)	381 mm (15.0 in)
838 mm (33.0 in)	178 mm (7.0 in)	533 mm (21.0 in)	254 mm (10.0 in)

An E-Stop has to be within 10 feet or 3 m of every operation and maintenance location. The location of the E-Stop could not be obstructed and must be easily visible.

