



Bulletin 150 SMC-Flex Protective Module Installation Instructions

Rated 5-85 Amps

(Cat. 150-F84, -F86)



ATTENTION: To prevent electrical shock, disconnect from power source before installing or servicing. Install in suitable enclosure. Keep free from contaminants.

Protective Module Installation (Line Side)

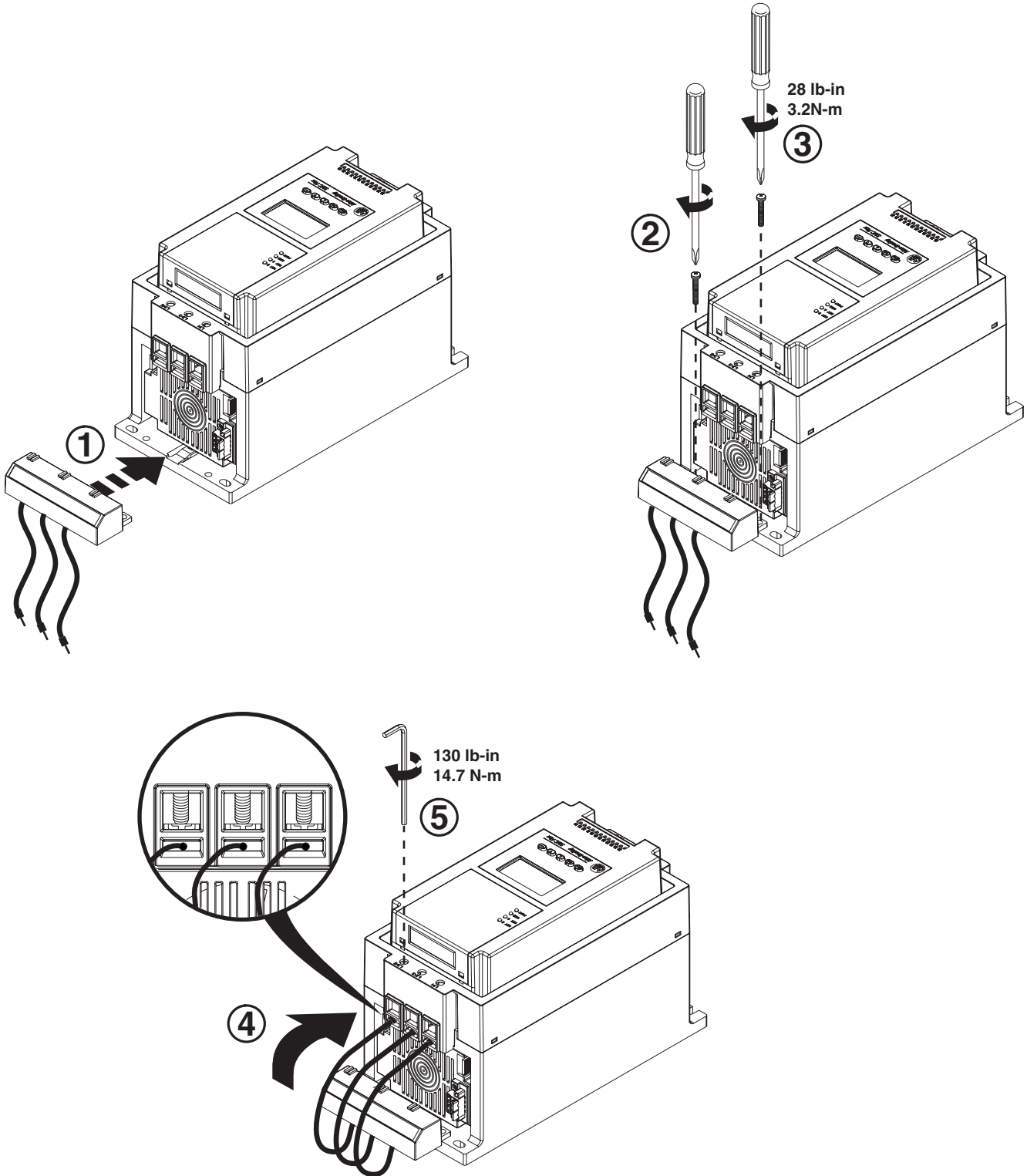

Protective Module Installation (Load Side)

