

InView™

INDUSTRIAL MESSAGE DISPLAYS



Quick Start Guide

2706-PENETx2-SC

www.spectrumcontrols.com



SPECTRUM
C O N T R O L S

Copyright ©2015 Spectrum Controls, Inc., all rights reserved. Part No. 0100249-04 Rev 9/2015

Setup for 2706-P22R-SC

Please follow these instructions to setup the P22R display.

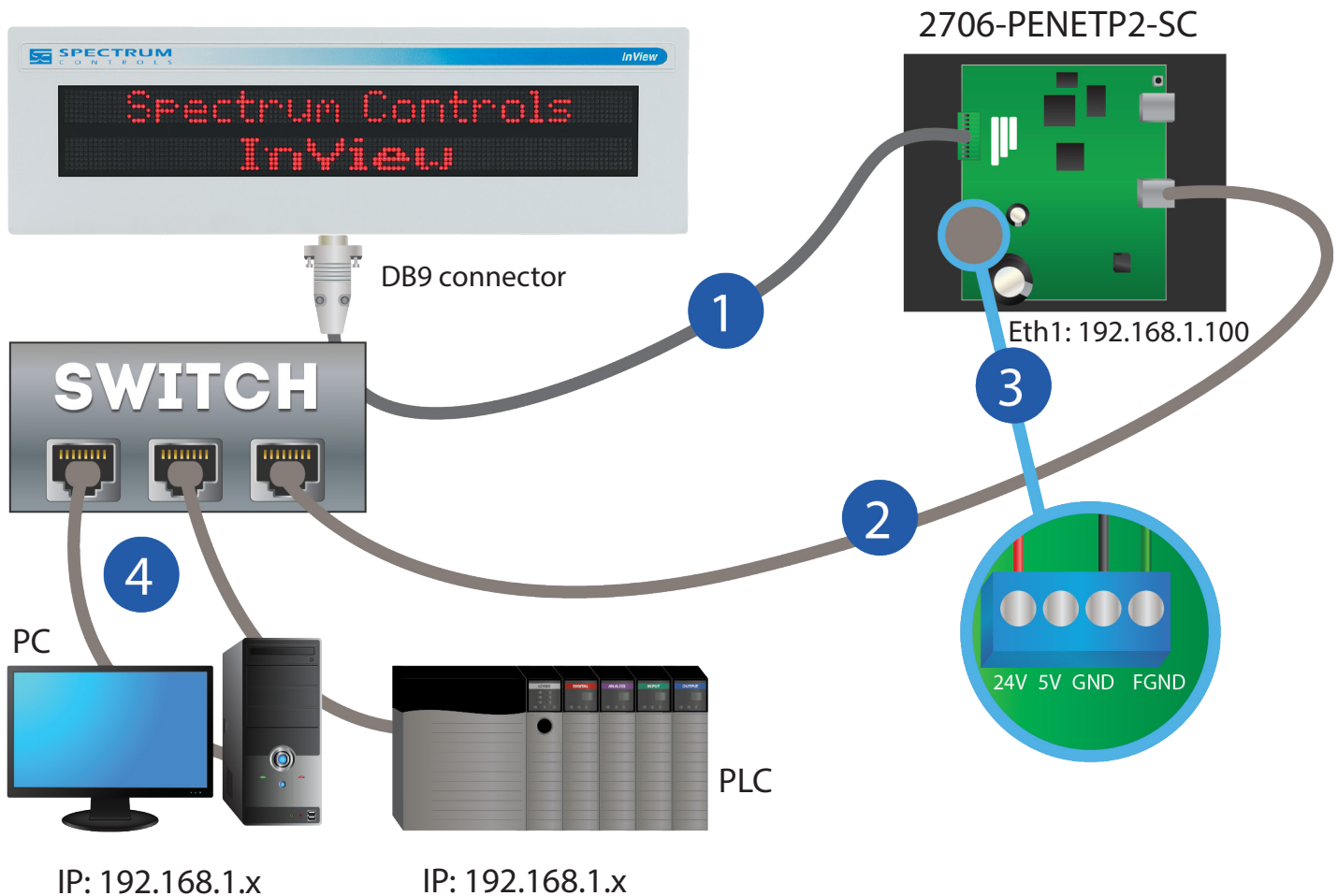

1 Connect the display to the communications module using supplied cable.

2 With a CAT5 cable, connect the comms module to an unmanaged switch.

3 Connect 24 VDC to comms module.

4 Connect the unmanaged switch to both your PC and PLC with a CAT5 cable.

IMPORTANT – PC & PLC must be in the 192.168.1.x subnet!

Setup for 2706-P4x-SC

Please follow these instructions to setup the P4x display.

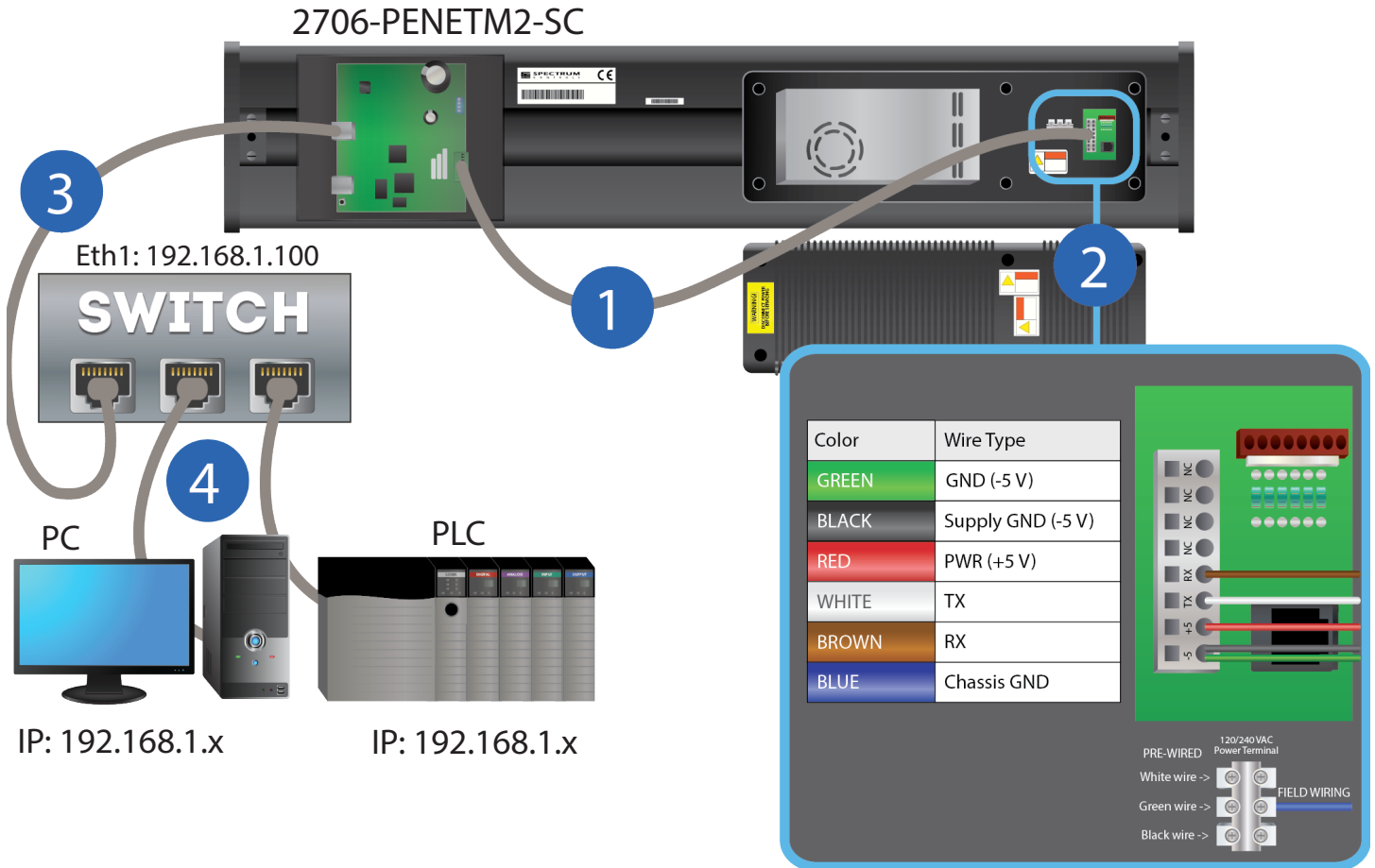

1 Connect the display to the communications module using supplied cable.

2 Wire the comms module as shown in the above wiring diagram.

3 With a CAT5 cable, connect the comms module to an unmanaged switch.

4 Connect the unmanaged switch to both your PC and PLC with a CAT5 cable.

IMPORTANT – PC & PLC must be in the 192.168.1.x subnet!

Setup for 2706-P7x-SC

Please follow these instructions to setup the P7x display.

2706-PENETK2-SC

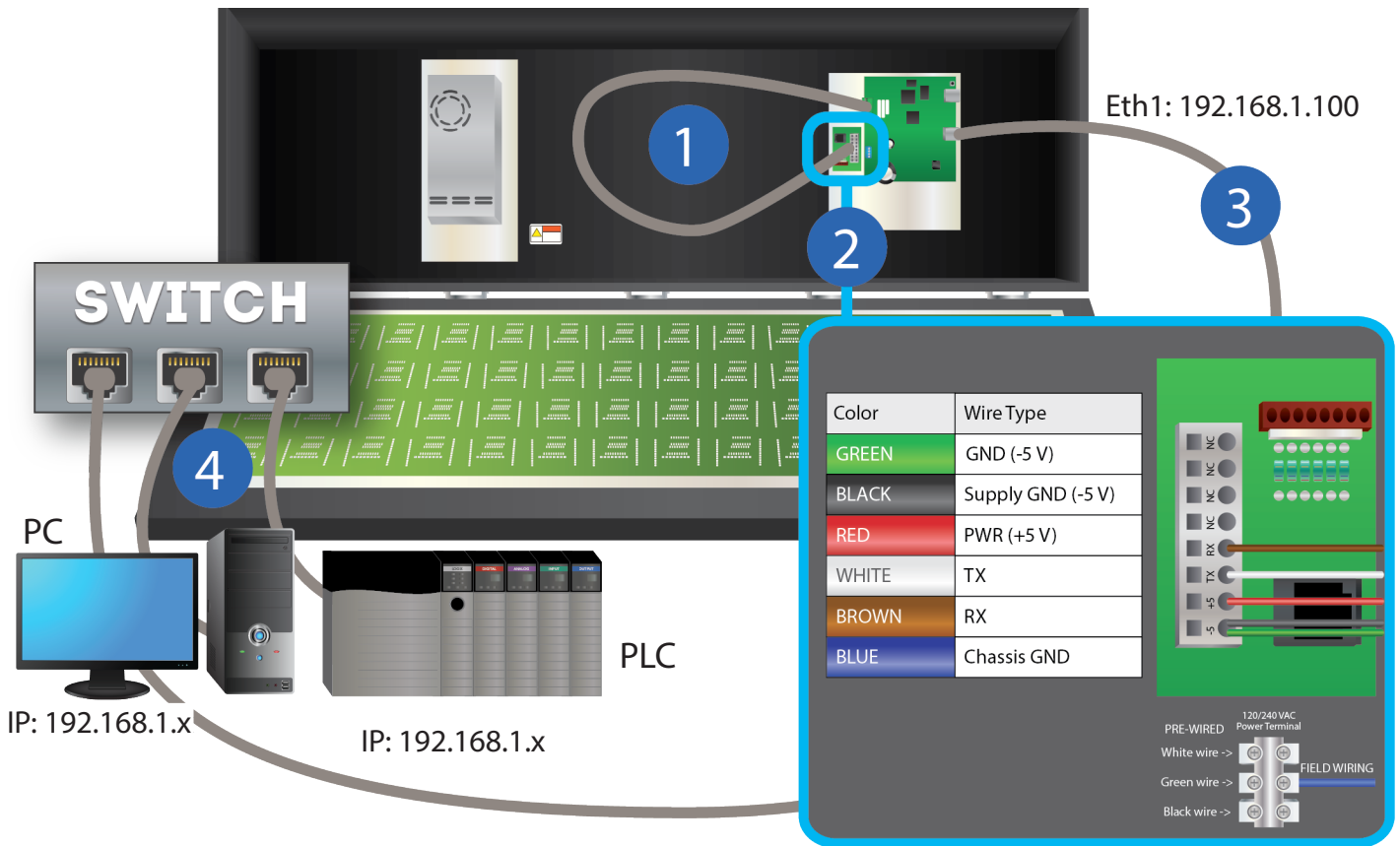

1 Connect the display to the communications module using supplied cable.

2 Wire the comms module as shown in the above wiring diagram.

3 With a CAT5 cable, connect the comms module to an unmanaged switch.

4 Connect the unmanaged switch to both your PC and PLC with a CAT5 cable.

IMPORTANT – PC & PLC must be in the 192.168.1.x subnet!

Setup for 2706-P9x-SC

Please follow these instructions to setup the P9x display.

2706-PENETK2-SC

Eth1: 192.168.1.100

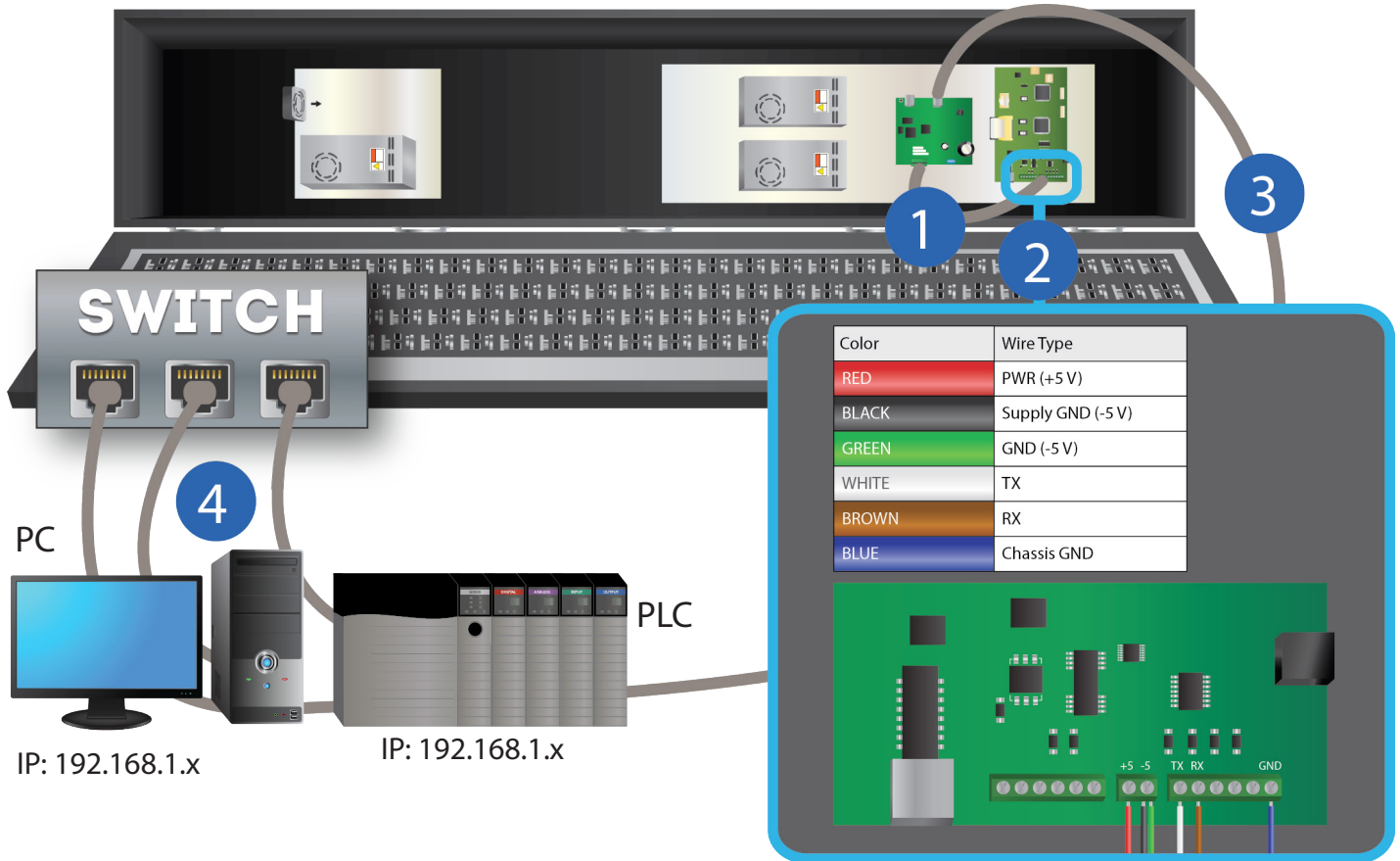

1 Connect the display to the communications module using supplied cable.

2 Wire the comms module as shown in the above wiring diagram.

3 With a CAT5 cable, connect the comms module to an unmanaged switch.

4 Connect the unmanaged switch to both your PC and PLC with a CAT5 cable.

IMPORTANT – PC & PLC must be in the 192.168.1.x subnet!

Setup for 2706-P9xC2-SC

Please follow these instructions to setup the P22R display.

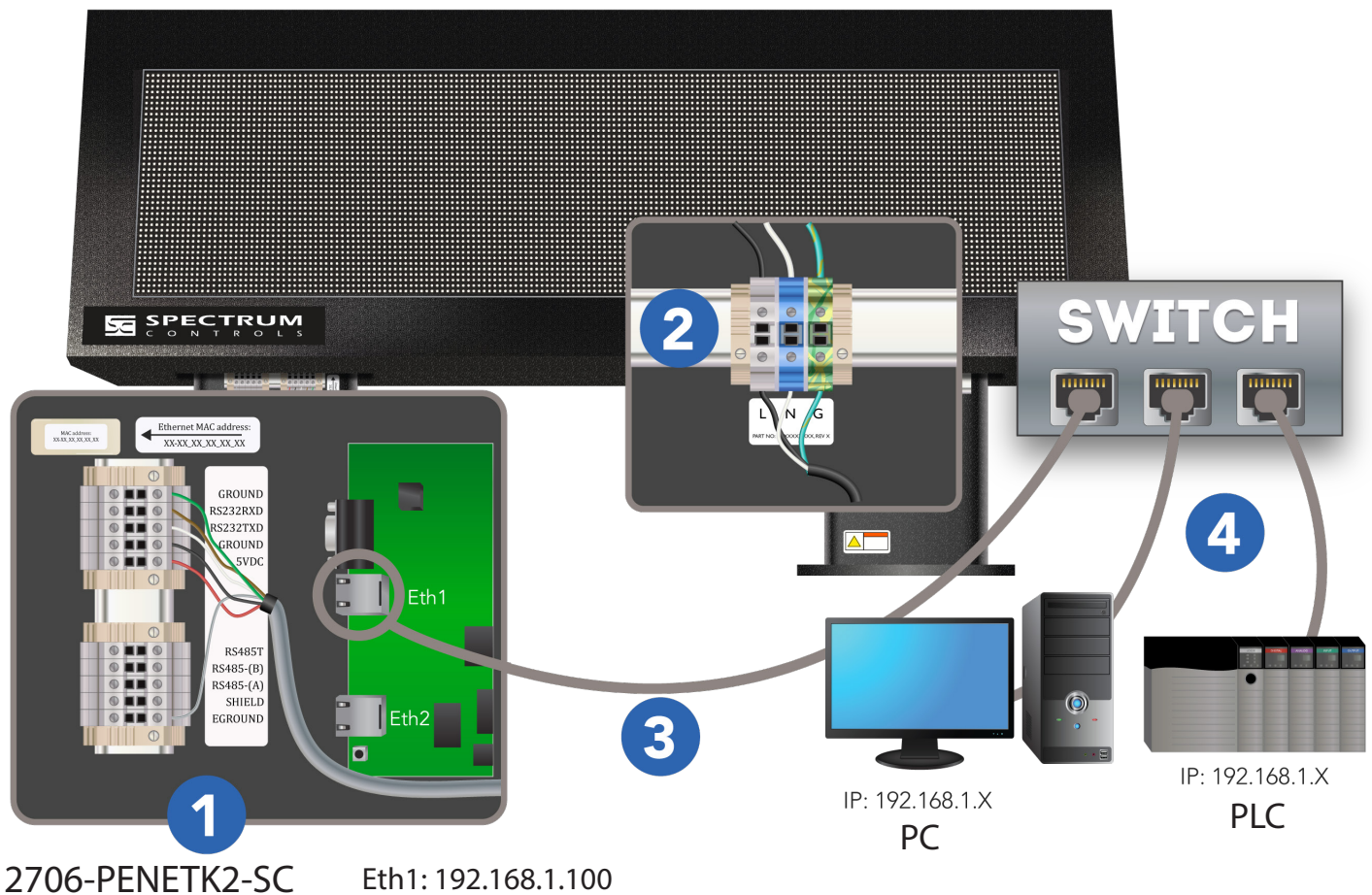

1 Wire the comms module to the display as shown in the above wiring diagram.

2 Connect power as shown in the above wiring diagram.

3 With CAT5 cable, connect the comms module to an unmanaged switch.

4 Connect the unmanaged switch to both your PC and PLC with CAT5 cable.

IMPORTANT – PC & PLC must be in the 192.168.1.x subnet!

Configuration for Comms Module

Please follow these 3 steps to setup the InView communications module.

Step 1 - Login

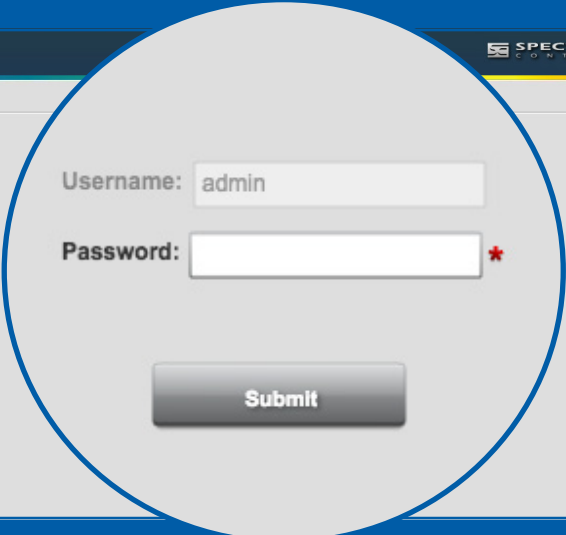

Username: admin
Password: *

Submit

Open your browser and navigate to "192.168.1.100"

Username: admin
Password: spectrum

Note: You will need to change your PC IP so it's in the same subnet

Step 2 - Network Setup

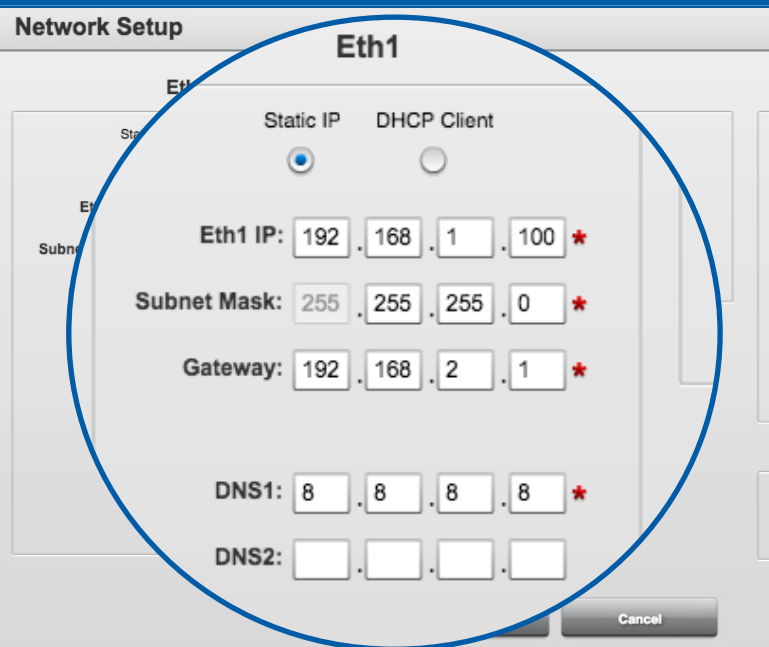

Network Setup

Eth1

Static IP DHCP Client

Eth1 IP: 192 . 168 . 1 . 100 *

Subnet Mask: 255 . 255 . 255 . 0 *

Gateway: 192 . 168 . 2 . 1 *

DNS1: 8 . 8 . 8 . 8 *

DNS2:

Cancel

Open Network Setup

Make sure the Eth1 IP setting matches your PLC network

Eth1 and Eth2 cannot be in the same subnet.

Note: The PC and the PLC must be in the same subnet as the InView Eth1 interface.

Note: Only use Eth1, leave Eth2 set to "DHCP"

Step 3 - PLC Setup

(For TCP/IP Passthrough, see below.)

The screenshot shows the 'PLC' configuration window. On the left, under 'PLC', the 'Msg Server Type' is set to 'ControlLogix'. Below it, 'Device Name' is 'inview_message_server', 'Connection' is 'Ethernet', 'Protocol' is 'EtherNet/IP', 'Address' is '10.0.0.223', 'TCP Port' is '44818', 'Slot Number' is '0', and 'Enable Polling' is checked with a 'Delay' of '100 ms'. A 'Test Device Connection' button is at the bottom. On the right, under 'Tag Setup', the 'Classic' radio button is selected. The 'Message Trigger' section has 'Tag Name' 'inview_mesg_trigger', 'Data Type' 'SINT', and 'Base Addr / Offset' '0'. The 'Message Data' section has 'Tag Name' 'inview_mesg_data', 'Data Type' 'SINT', 'Base Addr / Offset' '1', and 'Array Size' '16 Bytes'.

Open PLC

Select your PLC and enter its IP address.

Enter your PLC server tag values.

Check the enable polling box.

Note: Both message and variable tags must exist on the PLC controller.

TCP/IP Passthrough

The screenshot shows the 'PLC' configuration window. The 'Msg Server Type' is set to 'Passthrough'. Below it, 'Connection' is 'Ethernet', 'Protocol' is 'TCP/IP', and 'TCP Port' is '3001'.

Open PLC

For TCP/IP passthrough, select "Passthrough" for the Msg Server Type.

Set the TCP Port



For more information, please access the InView context-sensitive online help by clicking on the blue button in the upper right corner of the user interface.

Please visit our website for links to the InView user manual, data sheets, install guides, software guides, and add-on instructions.
www.spectrumcontrols.com/InView.html

1705 132nd Ave NE, Bellevue, WA 98005
Telephone : +1 (425) 746-9481 Email: spectrum@spectrumcontrols.com

Specifications subject to change without notice. Printed in USA

