



GHG 635 (25 A)

Technical data

Ex-manual motor starter GHG 635 (25 A)

Marking accd. to 2014/34/EU	Ⓔ II 2 G Ex ed IIC T5/T6 / Ⓔ II 2 D Ex tD A21 IP66 T80 °C	
EC-Type Examination Certificate	PTB 99 ATEX 1162	
IECEX Certificate of Conformity	IECEX BK1 08.0014	
Marking accd. to IECEx	Ex d IIC T6/ Ex tD A21 IP66 T80 °C	
Permissible ambient temperature	at T6 I _e ≤ 16 A -20 °C up to +40 °C at T5 I _e > 16 A; ≤ 25 A -20 °C up to +55 °C	
Rated voltage	up to max. 690 V	
Rated current	max. 25 A	
Rated current aux. contact	max. 2 A	
Frequency	50/60 Hz	
Rated making/breaking capacity AC-3 accd. EN 60947-4-1	U _e 690 V / I _e 25 A	
Back-up fuse	see table	
Undervoltage trip	tripping at 15 % - 75 % U _n can be switched on at U > 80 % U _c	
Connecting terminals	main contact	10 mm ²
	auxiliary-/Signal contact	2 x 0.75 - 4.0 mm ²
Thermal tripping characteristic	T II	
Protection class	I	
Degree of protection accd. to EN 60529	IP66	
Cable glands/enclosure drilling	0.1 - 6.3 A 2 x M25 cable gland ¹⁾ 6.3 - 25 A 2 x M32 cable gland ¹⁾ , optional metal flange with thread	
Weight	2.5 kg	
Enclosure material	glass-fibre reinforced polyester	
Enclosure colour	black	
Padlocking facility	can be locked in OFF position with 3 commercially available padlocks (Ø max. 6 mm)	

¹⁾ Version with aux. contact or under voltage trip with additional cable gland M25

GHG 635-1 Ex-manual motor starters



GHG 635 (25 A)

Ordering coding for special version

Description	Content	Undervoltage trip	Aux. contact	R...
GHG 635 1	A	B	C	R...

Coding

A	Content	1	=	Standard version
B	Undervoltage trip	0	=	without undervoltage trip
		1	=	undervoltage trip 230 V
		2	=	undervoltage trip 400 V
		3	=	undervoltage trip 440 V
		4	=	undervoltage trip 500 V
		5	=	undervoltage trip 24 V
		6	=	undervoltage trip 48 V
		7	=	undervoltage trip 60 V
		8	=	undervoltage trip 110 V
9	=	undervoltage trip 415 V		
C	Auxiliary contact	1	=	without aux. contact
		2	=	with aux. contact 1 NO + 1 NC
		3	=	with aux. contact 2 NO

Short-circuit protection up to 100 kA and maximum backup fuse

Setting range	230 V AC		400 V AC		500 V AC		690 V AC		Temp Class	Order No.				
	Ics	gG, aM	Ics	gG, aM	Ics	gG, aM	Ics	gG, aM		A	B	C	R...	
0.1 A ... 0.16 A									T6	GHG 635 1	1	0	1	R0101
0.16 A ... 0.25 A									T6	GHG 635 1	1	0	1	R0102
0.25 A ... 0.40 A									T6	GHG 635 1	1	0	1	R0103
0.40 A ... 0.63 A									T6	GHG 635 1	1	0	1	R0104
0.63 A ... 1.0 A									T6	GHG 635 1	1	0	1	R0105
1.0 A ... 1.6 A									T6	GHG 635 1	1	0	1	R0106
1.6 A ... 2.5 A							40 kA	25 A	T6	GHG 635 1	1	0	1	R0107
2.5 A ... 4.0 A					40 kA	35/40 A	10 kA	40 A	T6	GHG 635 1	1	0	1	R0108
4.0 A ... 6.3 A					30 kA	50 A	3 kA	40 A	T6	GHG 635 1	1	0	1	R0109
6.3 A ... 9.0 A					30 kA	80 A	3 kA	50 A	T6	GHG 635 1	1	0	1	R0110
9.0 A ... 12.5 A			50 kA	80 A	20 kA	80 A	3 kA	50 A	T6	GHG 635 1	1	0	1	R0111
12.5 A ... 16.0 A			50 kA	100 A	20 kA	100 A	3 kA	50 A	T6	GHG 635 1	1	0	1	R0112
16.0 A ... 20.0 A			50 kA	100 A	20 kA	100 A	2 kA	50 A	T5	GHG 635 1	1	0	1	R0113
20.0 A ... 25.0 A	50 kA	125 A	50 kA	125 A	20 kA	125 A	2 kA	50 A	T5	GHG 635 1	1	0	1	R0114

Customized version on request



GHG 635 (25 A)

Accessories

Type	Application	Fixing method	Order No.
Mounting plate for Ex-Main current switches 25 A			
Size 3	Wall mounting	screwless mounting	GHG 610 1953 R0118
Size 3	Pipe clamp	screwless mounting	GHG 610 1953 R0110
Size 3	Trellis-work mounting	screwless mounting	GHG 610 1953 R0118

Type	OU	Order No.
------	----	-----------

Accessories for mounting plates

Label holder with type label (blank) for mounting plate size 1, 2, 2A and 3	10	GHG 610 1953 R0057
Mounting set for pipes 1" (of 27 - 30 mm) for mounting plates with pipe fixing	10	GHG 610 1953 R0020

Type	Application	OU	Order No.
------	-------------	----	-----------

Protective canopy for mounting plate

Size 3	for pipe mounting plate size 3 vertical	1	GHG 610 1955 R0104
Size 3A	for mounting plates wall/trellis fixing size 3 vertical	1	GHG 610 1955 R0105
Size 3B	for mounting plates pipe fixing size 3 horizontal	1	GHG 610 1955 R0106

Please pay attention that only order units (OU) according to the ordering details can be delivered.

Dimension drawing Wiring diagram

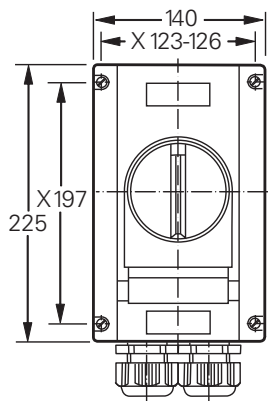

GHG 635

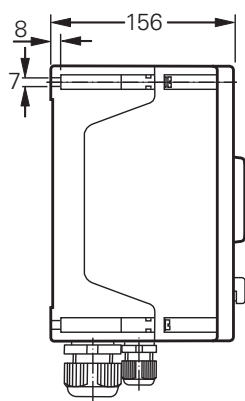

X = fixing dimensions

